



GENESIS INTERNATIONAL, INC.

SHERLOCK SERVICE BUDDY



SERVICE BUDDY IN CARRYING CASE
PART NUMBER 88-0395

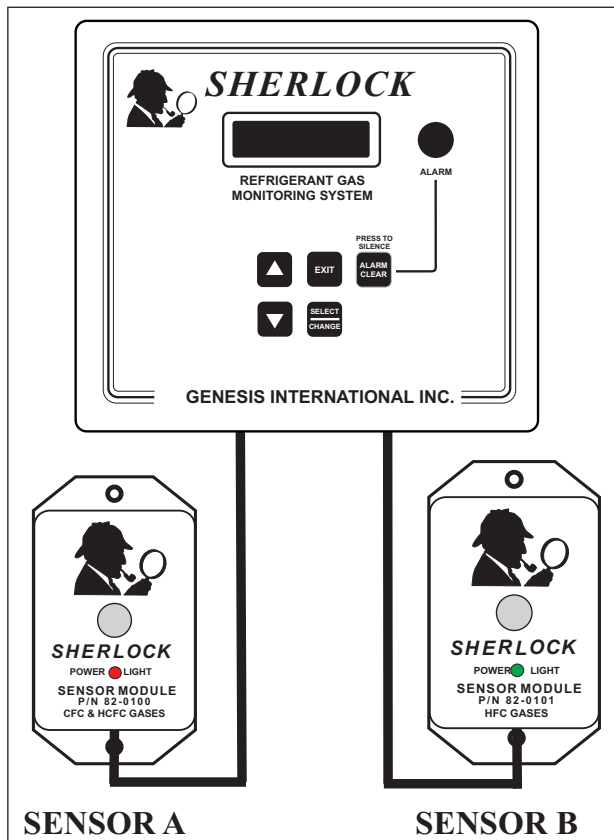

OVERVIEW

The SHERLOCK Service Buddy Portable Refrigerant Gas Monitor is for applications that require a service technician to install or service refrigeration equipment in an area that is not protected by a refrigerant gas monitoring system. The portable unit comes complete with a molded plastic carrying case, a SHERLOCK 202 Control Module, a 90dB buzzer, two Solid State CMOS refrigerant gas sensors and a 120V wall plug cord. All alarm levels are factory programmed and user settable, depending upon refrigerant.

ENCLOSURE Molded ABS Plastic "briefcase"
12"H x 16"W x 4"D

ENVIRONMENT 10 to 120 °F (-10 to 50 °C)
0 to 95 % RH non condensing

POWER 120VAC, 500MA, 50/60Hz

INPUTS CMOS CFC/HCFC and
CMOS HFC sensor.

OUTPUTS Four Dry Contact Relays, SPDT,
1 Form C, rated for 250VAC,
3.15 Amps.

ALARMS Two Gas Concentration Alarm
Levels (2 Relays per Level).

DISPLAY 2 Line by 16 Characters Alpha-
Numeric Liquid Crystal Display
(LCD).

ALARM INDICATORS

LCD Display Displays Name and current read-
ing of alarming sensor.

Buzzer Piezo-Electric, 90dB @ 2 ft buzzer
activates for all alarm conditions.
Buzzer is silenced by pressing any
key. Will re-activate in 30 minutes
if alarm condition is not corrected.

Flashing LED Visible from all angles.

OPERATING INSTRUCTIONS

1. Plug Power Plug into a 110Vac wall outlet.
 2. Choose appropriate gas from gas list.
 3. Note correct sensor reading Part number 82-0100 (Sensor A) CFC/HCFC sensor or Part number 82-0101 (Sensor B) for HFC sensor.
 4. Allow ½ hour warm-up time.
- (NOTE: There could be some significant cross sensitivity with both sensors.)

MISCELLANEOUS

User definable alarm setpoints and delays.

Simple 3-wire low voltage sensor wiring PRE-WIRED.

Continuous monitoring of sensor.

Each alarm level has a two SPDT relays.

Display constantly shows sensor levels, alarm setpoints and current alarm status.

Each relay can be set for a "Energized to Alarm" (NO) mode or a fail-safe "De-Energize to Alarm" (NC) mode.

Capable of monitoring multiple gases.

Menu-driven field calibration, with optional scientific air calibration kit

Optional GenCom Remote Communications.

Effective monitoring range from 25 to 1000 PPM

Programmable setback timer and two manual setback inputs to reduce false alarms.

Built in 95db alarm buzzer

Refrigerant gas monitor provides early warning for applications that require a service technician to install or service equipment in an area that is unprotected from refrigerant leaks.

SENSOR CROSS REFERENCE CHART FOR SERVICE BUDDY

Gas	Name	Type	Group	Sherlock Sensor	Gas	Name	Type	Group	Sherlock Sensor
R-11		CFC	A1	#82-0100	R-402A	HP80	HCFC	A1/A1	#82-0101
R-12		CFC	A1	#82-0100	R-402B	HP81	HCFC	A1/A1	#82-0100
R-13		CFC	A1	#82-0100	R-403A	R-69S	HCFC	A1/A1	#82-0100
R-13B1		BFC	A1	NA	R-403B	R-69L	HCFC	A1/A1	#82-0100
R-14		PFC	A1	NA	R-404A	HP62	HFC	A1/A1	#82-0101
R-22		HCFC	A1	#82-0100	R-405A	G2015	HCFC	A1/A1	#82-0100
R-23		HFC	A1	#82-0101	R-406A	CHG	HCFC	A1/A2	#82-0100
R-32		HFC	A2	#82-0100	R-407A	Klea 60	HFC	A1/A1	#82-0101
R-113		CFC	A1	#82-0100	R-407B	Klea 61	HFC	A1/A1	#82-0101
R-114		CFC	A1	NA	R-407C	9000	HFC	A1/A1	#82-0101
R-115		CFC	A1	NA	R-407D	Klea	HFC	A1/A1	#82-0101
R-116		PFC	A1	NA	R-408A	FX10	HCFC	A1/A1	#82-0101
R-123		HCFC	B1	#82-0101	R-409A	FX56	HCFC	A1/A1	#82-0100
R-124		HCFC	A1	#82-0100	R-410A	AZ20	HFC	A1/A1	#82-0101
R-125		HFC	A1	#82-0101	R-410B	9100	HFC	A1/A1	#82-0101
R-134A		HFC	A1	#82-0101	R-411A	G2018A	HCFC	A1/A2	#82-0100
R-142B		HCFC	A2	#82-0100	R-411B	G2018B	HCFC	A1/A2	#82-0100
R-143A		HFC	A2	#82-0101	R-412A	TP5R	HCFC	A1/A2	#82-0100
R-152A		HFC	A2	#82-0101	R-413A		HFC	A2/A2	#82-0101
R-218		PFC	A1	NA	R-500		CFC	A1	#82-0100
R-290		HC	A3	#82-0100	R-502		CFC	A1	#82-0100
R-C318		PFC	A3	NA	R-503		HFC	A1	#82-0101
R-600a		HC	A3	NA	R-507A	AZ50	HFC	A1/A1	#82-0101
R-1270		HC	A3	NA	R-508A	Klea5R3	HFC	A1/A1	#82-0100
R-400	Lintern	CFC	A1/A1	#82-0100	R-508B	SUVA95	HFC	A1/A1	#82-0101
R-401A	MP89	HCFC	A1/A1	#82-0101	R-509A	TP5R2	HFC	A1/A1	#82-0100
R-401B	MP66	HCFC	A1/A1	#82-0101	R-717	Ammonia	NH3		#82-0102
R-401C	MP52	HCFC	A1/A1	#82-0101	R-744				

Note: If the gas you would like to detect is not listed, please call the factory for verification.



GENESIS INTERNATIONAL, INC.

1040 FOX CHASE INDUSTRIAL DRIVE
ARNOLD, MISSOURI 63010

PHONE: (636) 282-0011
FAX: (636) 282-2722

WEBSITE:
WWW.GENESIS-INTERNATIONAL.COM

EMAIL:
MAIL@GENESIS-INTERNATIONAL.COM